

DWG BY:	DATE:	REVISION DESCRIPTION	BY:
DC	AUG. 4, 2021		
NTS		AS PER FAX/EMAIL AUG 9, 2021	

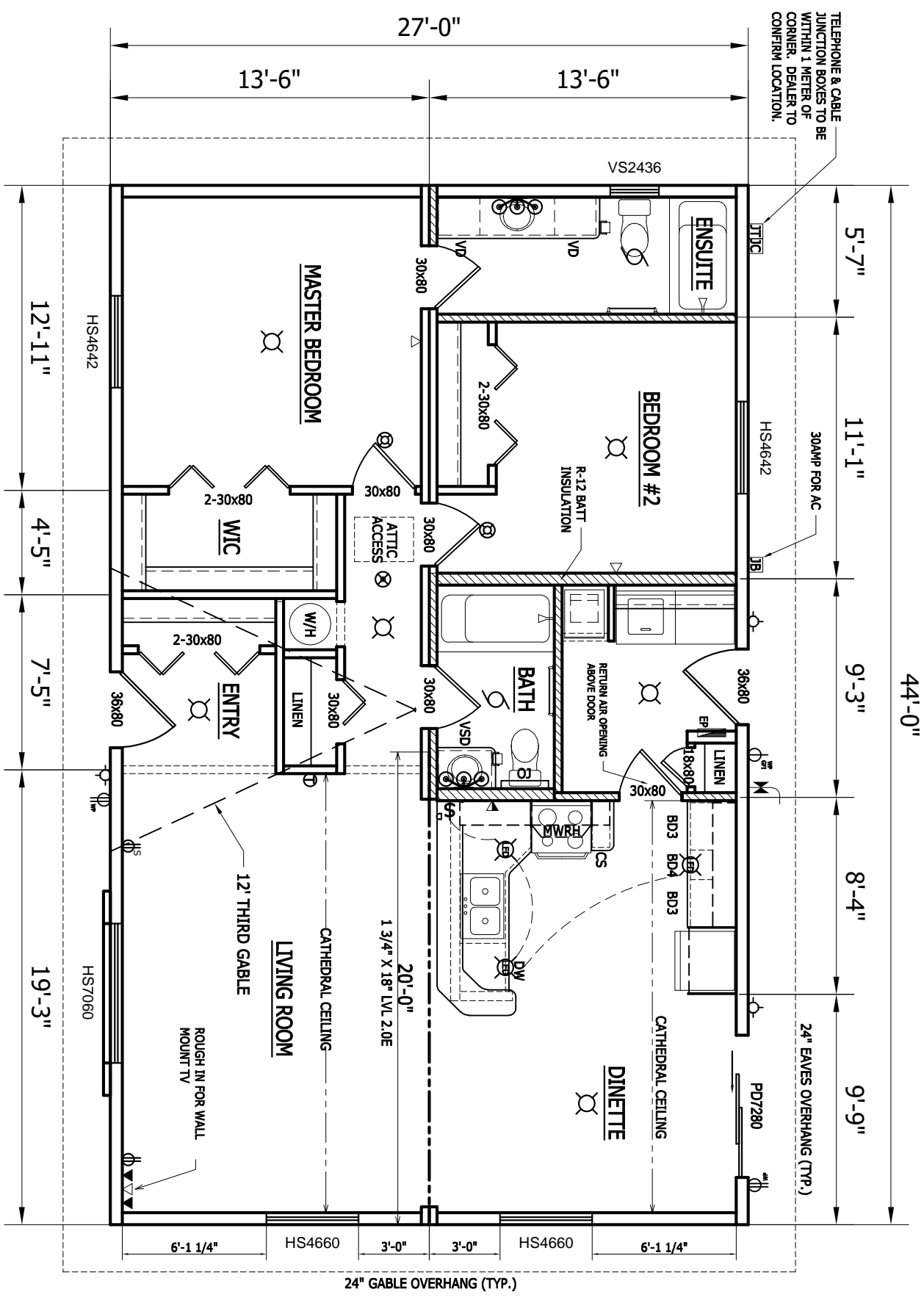

NOTE:
 1. BARE FLOOR THROUGHOUT.

Please Sign and Return in 1 Day:

	= MICROWAVE
	= RECYCLE/TRASH B
	= KITCHEN DRAWER
	= LAZY SUSAN
	= VANITY DRAWER
	= MICROWAVE/RNG/C
	= REC. MED. CAB.
	= ELECTRICAL PAN
	= RI PHONE CAB
	= PREMISE CABL
	= PREWIRE PHONI
	= RECEPTAC
	= SWITCHED RECEP
	= SWITCHED RECEP
	= EXTERIOR RECEP
	= SWITCH
	= 3 WAY SWITCH
	= EXTERIOR LIGH
	= CEILING LIGHT
	= DUAL HEAD EMER
	= EMERGENCY COMB
	= EMERGENCY LIGH
	= FLUORESCENT
	= UNDERCAB HALO
	= CEILING FAN
	= LIGHT COMBO.
	= VANITY LIGHT
	= SCONCE LIGHT
	= BATH FAN
	= CO2 SMOKE COM
	= SMOKE ALARM
	= DOOR CHIMES
	= EXT DOOR CHIM
	= FLOOR
	= J.B. @ ATTIC
	= CABLE/PHONE.
	= FROST FREE TA
	= FURNACE
	= WATER HEATER
	= WASHER/DRYER